

ONE BARTHOLOMEW
BARTS SQUARE LONDON

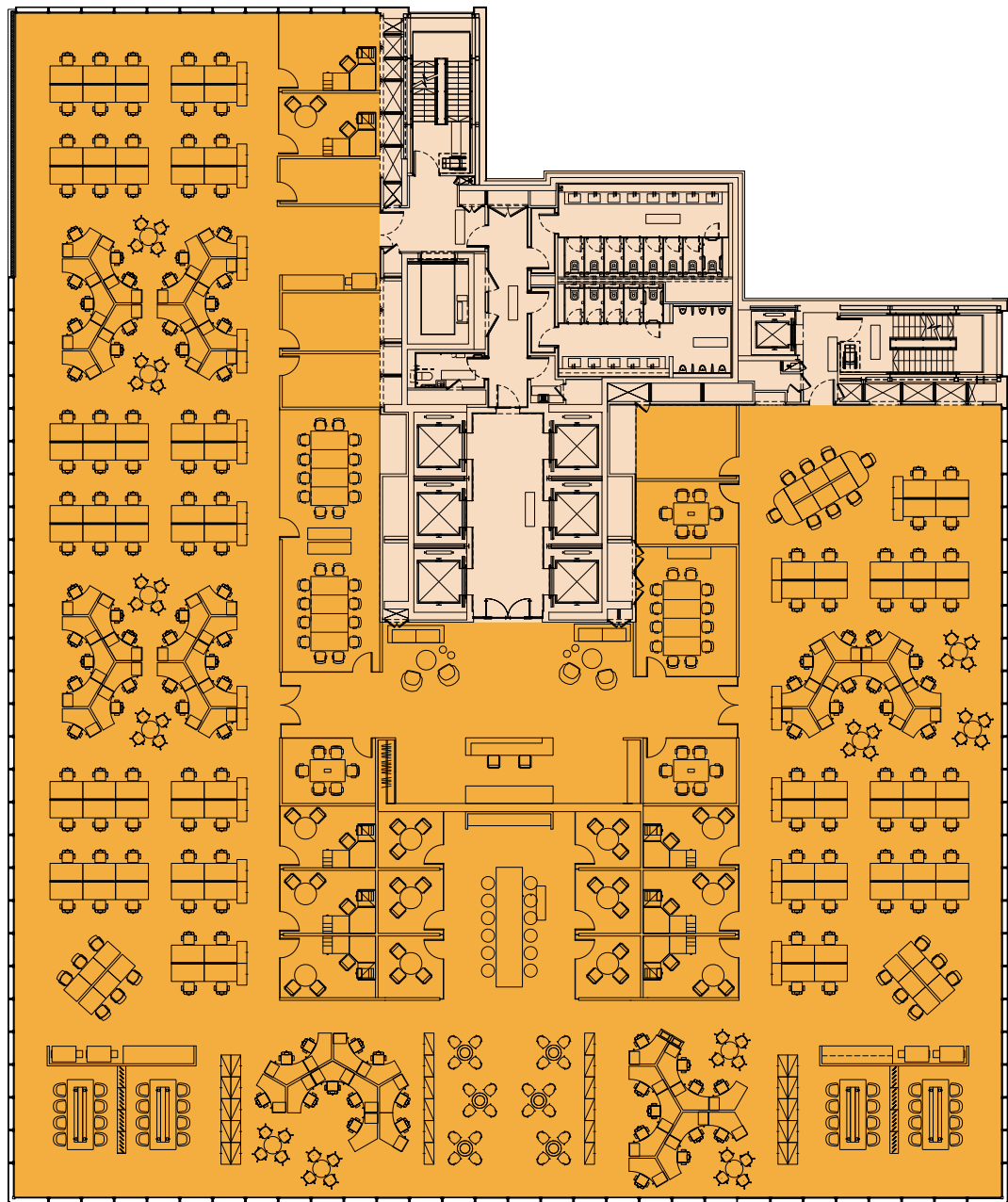

MEDIA - SINGLE FLOOR OCCUPANCY

| | |
|------------------------|-----|
| Open plan | 172 |
| Reception | 1 |
| 12 person meeting room | 3 |
| 6 person meeting room | 3 |
| Meeting/quiet room | 6 |
| Offices | 8 |
| Team space | 2 |

| | |
|----------------|---------|
| Cafe/breakout | 1 |
| Copy/tea point | 3 |
| Server/AV room | 2 |
| First aid room | 1 |
| Store room | 1 |
| Area sq ft | 19,580 |
| Area sq m | 1,819.0 |
| Occupancy 1:10 | 180 |

| | |
|--------|------|
| KEY | |
| Office | Core |

ONE BARTHOLOMEW
BARTS SQUARE LONDON

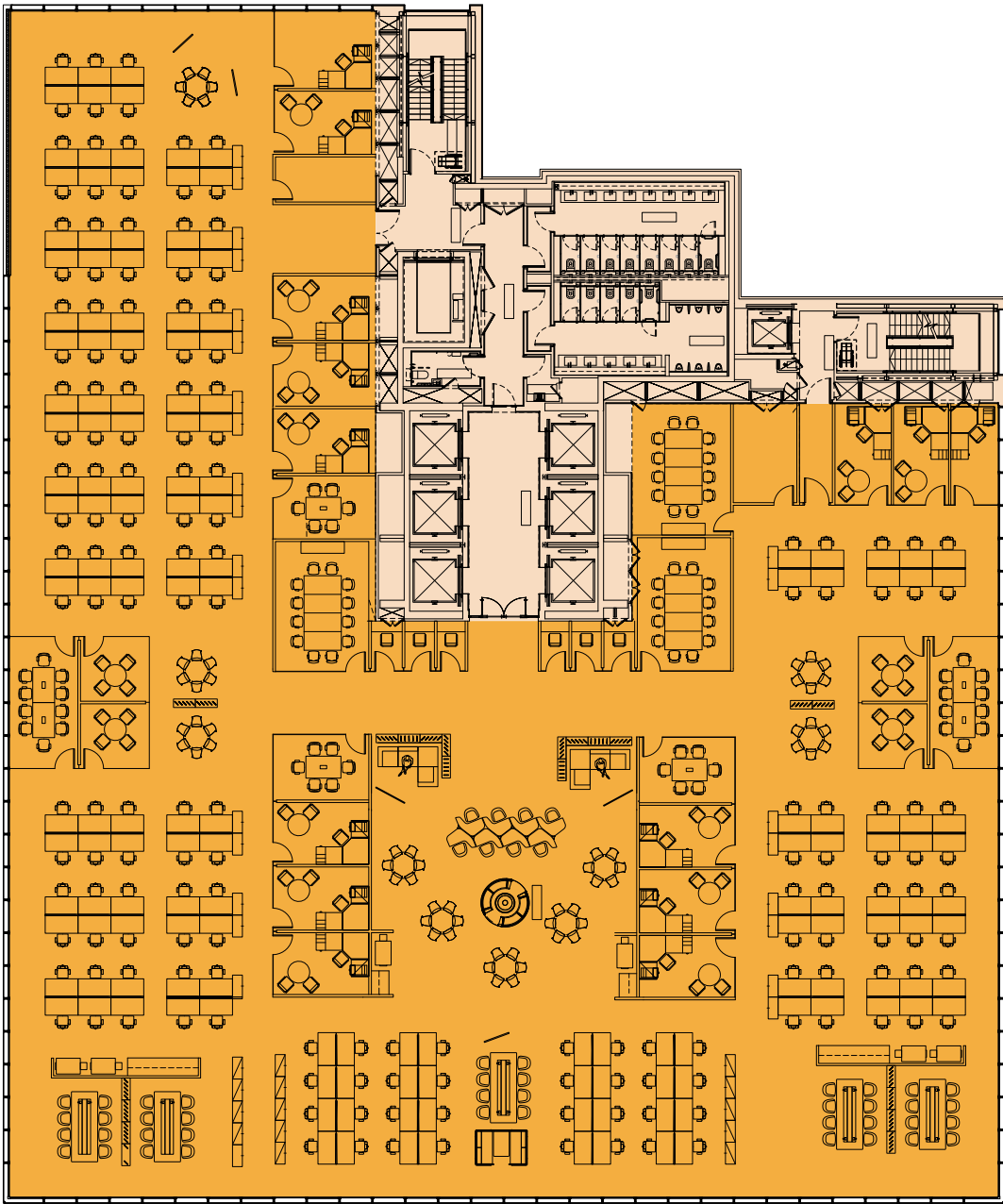

CORPORATE - MULTIPLE FLOOR OCCUPANCY

| | |
|--------------------------|-----|
| Open plan | 168 |
| 12 person meeting room | 3 |
| 6-10 person meeting room | 5 |
| Offices | 13 |
| Team space | 7 |
| Phone booth | 6 |

| | |
|----------------|---------|
| Hub/breakout | 1 |
| Copy/tea point | 3 |
| Server/AV room | 2 |
| Store room | 1 |
| Area sq ft | 19,580 |
| Area sq m | 1,819.0 |
| Occupancy 1:10 | 181 |

| | |
|--------|------|
| KEY | |
| Office | Core |